

PROPERTY FLOOR PLAN

File No 05/19/10

Property Address 1211 Padre Ln.

City Pebble Beach

County Monterey

State CA

Zip 93953

Peter Butler

Carmel Realty Company

Dolores and Seventh, Carmel, CA

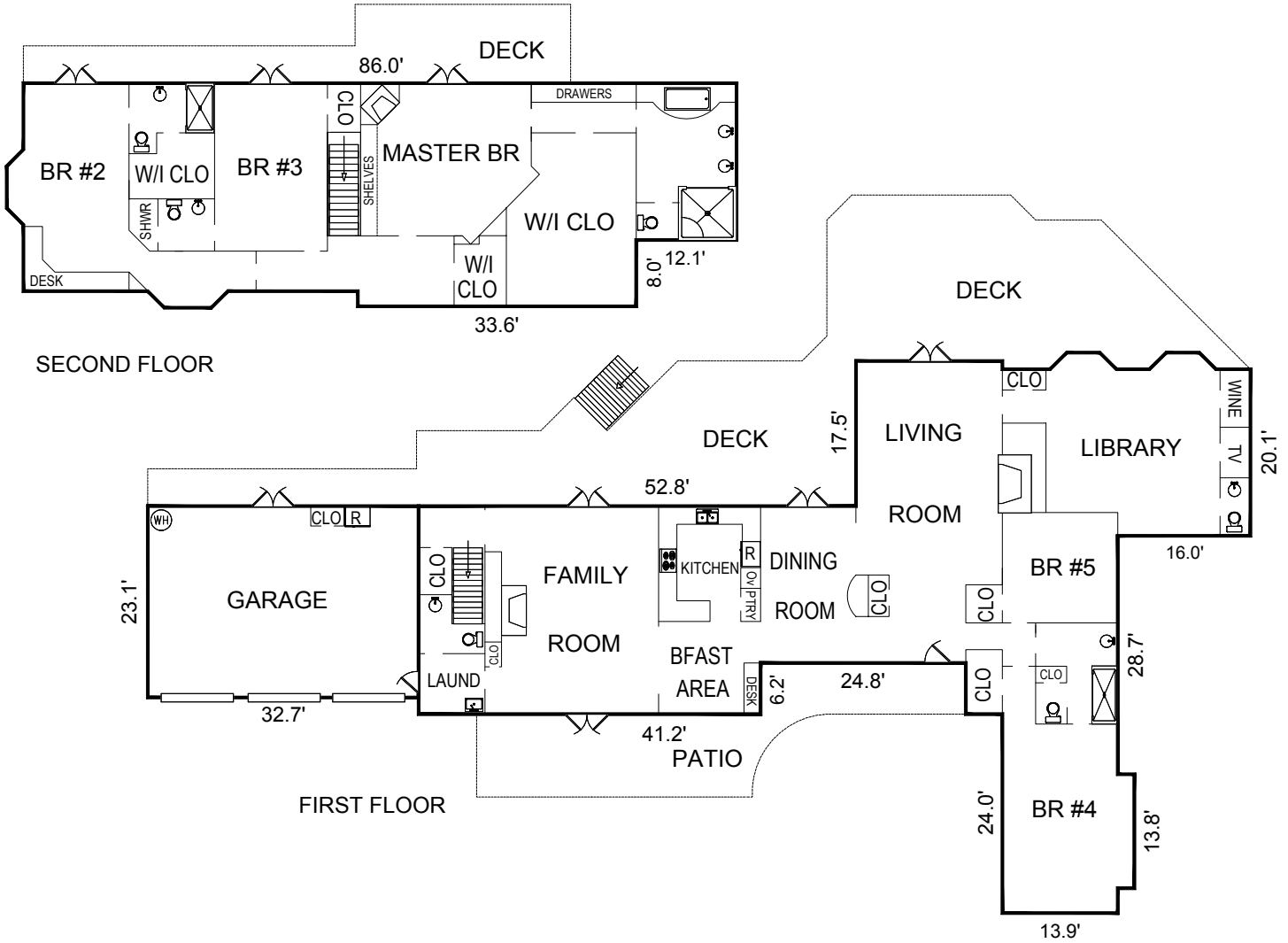

AREA CALCULATIONS SUMMARY			
Code	Description	Net Size	Net Totals
GLA1	First Floor	3208.4	3208.4
GLA2	Second Floor	2124.0	2124.0
P/P	Deck	1643.8	
	Deck	427.0	
	Stone Patio	504.3	2575.1
GAR	Garage	754.1	754.1
OTH	Stairway	50.0	50.0
Net LIVABLE Area		(Rounded)	5332

LIVING AREA BREAKDOWN	
Kitchen:	14'4" x 11'9"
Bfast Area:	11'9" x 10'7"
Dining Room:	18'7" x 11'8"
Living Room:	25'5" x 17'2"
Family Room:	24' x 15'9"
Library:	22'8" x 18'9"
Master BR:	18' x 17'9"
Bedroom #2:	24' x 12'9"
Bedroom #3:	19'8" x 13'2"
Bedroom #4:	22' x 12'9"
Bedroom #5:	12'9" x 12'9"