

PROPERTY FLOOR PLAN

File No 09/25/08

Property Address 1046 Rodeo Rd.

City Pebble Beach

County Monterey

State CA

Zip 93953

Hallie Mitchell Dow

Sotheby's International Realty

Dolores and Seventh, Carmel, CA

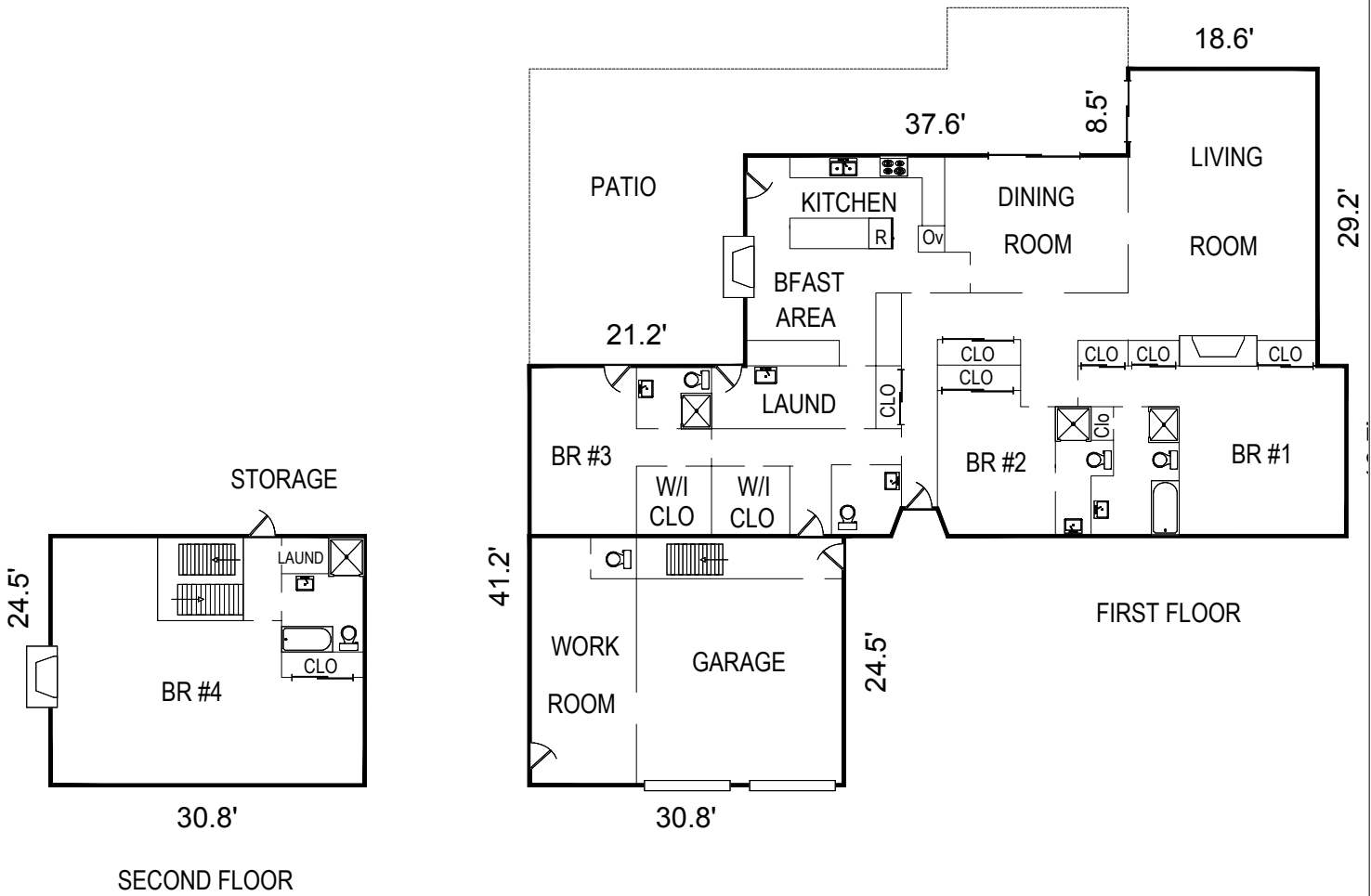

AREA CALCULATIONS SUMMARY			
Code	Description	Net Size	Net Totals
GLA1	First Floor	2645.3	2645.3
GLA2	Second Floor	754.4	
	Stairway	-69.9	684.5
P/P	Patio	1043.3	1043.3
GAR	Garage	754.4	754.4
Net LIVABLE Area		(Rounded)	3330

LIVING AREA BREAKDOWN	
Breakdown	Subtotals
Kitchen: 18' x 8.5"	
Bfast Area: 13.6" x 11.6"	
Dining Room: 17.6" x 13'	
Living Room: 25.4" x 17.3"	
Bedroom #1: 16' x 15.5"	
Bedroom #2: 12.9" x 11.2"	
Bedroom #3: 16' x 10'	
Bedroom #4: 30' x 15.8"	